

PRODUCTOS COMPLEMENTARIOS

TUBERIA Y RACORES PARA AIRE COMPRIMIDO

aircom



distribuidos por
**METAL
WORK**
PNEUMATIC

Tubo en aluminio

Z33QLTUAL

Tubo en aluminio

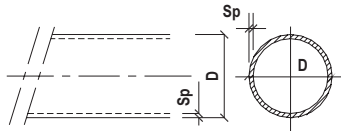

Código	Gr/m	D	Barra	sp
Z33QLTUAL6020	201	20	6 mts.	1,3
Z33QLTUAL6025	273	25	6 mts.	1,4
Z33QLTUAL6032	402	32	6 mts.	1,5
Z33QLTUAL6040	586	40	6 mts.	1,8
Z33QLTUAL6050	819	50	6 mts.	2
Z33QLTUAL6063	1039	63	6 mts.	2
Z33QLTUAL6080	1582	80	6 mts.	2,4
Z33QLTUAL3016	101	16	3 mts.	1
Z33QLTUAL3020	201	20	3 mts.	1,3
Z33QLTUAL3025	273	25	3 mts.	1,4
Z33QLTUAL3032	402	32	3 mts.	1,5
Z33QLTUAL3040	586	40	3 mts.	1,8

Z33QLTUALG

Tubo en aluminio verde (agua)

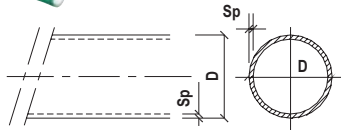
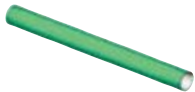

Código	Gr/m	D	Barra	sp
Z33QLTUALG6020	201	20	6	1,5
Z33QLTUALG6025	273	25	6	1,5
Z33QLTUALG6040	586	40	6	2

Z33QLSCI

Doble Curva

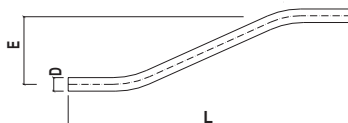

Código	Gr	D	L	E
Z33QLSCI016	70	16	-	-
Z33QLSCI020	100	20	43	13
Z33QLSCI025	130	25	46	16

DATOS TECNICOS

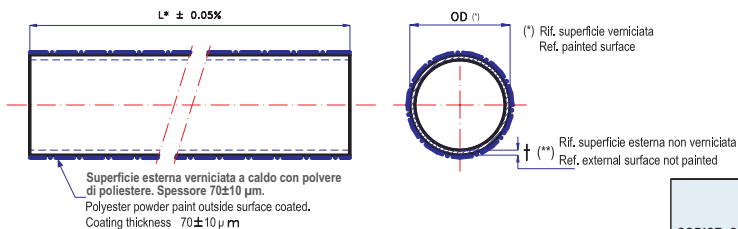

Presi6ne de utilizaci6n m6xima

13 bar da -10°C a 90°C

Test de resistencia a la presi6n interna

XX bar per 1 ora a 20°C

Materiale

Lega di alluminio per estrusione EN AW 6060 T6 UNI-EN 755-2

Colore

Blu Ral 5012

Sistema di produzi6ne

Estrusione senza saldatura

CODICE CODE	DIMENSIONI (mm) DIMENSIONS (mm)					DIMENSIONI (pollici) DIMENSIONS (in)					Qty/Pack
	OD Diámetro Exterior Outside Diameter	±	Qualitaci6n Quality	t Espesora Thickness	±	OD Diámetro Exterior Outside Diameter	±	Qualitaci6n Quality	t Espesora Thickness	±	
AIRTUAL016	16	±0,1	0,2	1,00	±0,1	0,629	±0,0039	0,008	0,039	±0,0039	
AIRTUAL020	20	+0,1 +0,3	0,3	1,30	+0,1 -0,2	0,787	+0,004 +0,012	0,008	0,051	+0,0039 -0,0078	10
AIRTUAL025	25	+0,1 +0,3	0,3	1,40	+0,1 -0,2	0,984	+0,004 +0,012	0,008	0,059	+0,0039 -0,0078	10
AIRTUAL032	32	+0,1 +0,3	0,3	1,50	+0,2 -0,1	1,259	+0,004 +0,012	0,008	0,059	+0,0078 -0,0039	5
AIRTUAL040	40	+0,1 +0,35	0,3	1,80	±0,2	1,574	+0,004 0	0,008	0,070	±0,0078	5
AIRTUAL050	50	+0,1 +0,5	0,4	2,00	±0,2	1,574	+0,004 +0,012	0,012	0,078	±0,0078	4
AIRTUAL063	63	+0,1 +0,5	0,4	2,00	±0,2	2,480	+0,004 0,016	0,012	0,078	±0,0078	3
AIRTUAL080	80	+0,1 +0,5	0,5	2,40	±0,2	3,140	+0,004 0,016	0,012	0,078	±0,0078	3
AIRTUAL110	110	+0,1 +0,5	0,5	2,50	±0,2	4,330	+0,004 0,016	0,012	0,078	±0,0078	2

Racor Quick Line Ø 16/50 mm

Z33QLMAPA

Manguito

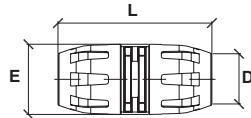

Código	Gr	D	L	E	C
Z33QLMAPA016	50	16	81	37	38
Z33QLMAPA020	90	20	98	45	48
Z33QLMAPA025	132	25	106	51	52
Z33QLMAPA032	212	32	124	61	62
Z33QLMAPA040	350	40	142	75	70
Z33QLMAPA050	505	50	161	87	79
Z33QLMAPA063	-	63	-	-	-

Z33QLMASPA

Manguito corredizo

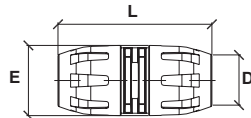

Código	Gr	D	L	E	C
Z33QLMASPA032	212	32	124	61	62
Z33QLMASPA040	350	40	142	75	70
Z33QLMASPA050	505	50	161	87	79
Z33QLMASPA063	-	63	-	-	-

Z33QLGO90PA

Codo de 90°

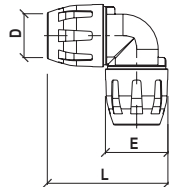

Código	Gr	D	L	E	C
Z33QLGO90PA016	70	16	72	37	38
Z33QLGO90PA020	100	20	86	45	48
Z33QLGO90PA025	140	25	95	51	52
Z33QLGO90PA032	240	32	122	61	62
Z33QLGO90PA040	390	40	130	75	70
Z33QLGO90PA050	580	50	152	87	79
Z33QLGO90PA063	-	63	-	-	-

Z33QLGO45PA

Codo de 45°

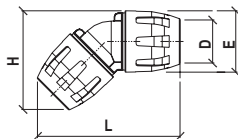

Código	Gr	D	L	H	E	C
Z33QLGO45PA020	100	20	104	72	45	48
Z33QLGO45PA025	145	25	115	81	51	52
Z33QLGO45PA032	235	32	137	97	61	62
Z33QLGO45PA040	375	40	160	115	75	70
Z33QLGO45PA050	540	50	185	134	87	79
Z33QLGO45PA063	-	63	-	-	-	-

Z33QLTEPA

Te de 90°

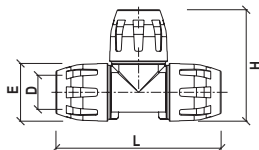

Código	Gr	D	L	E	H	C
Z33QLTEPA016	90	16	109	37	73	38
Z33QLTEPA020	160	20	127	45	86	48
Z33QLTEPA025	210	25	140	51	95	52
Z33QLTEPA032	360	32	170	61	122	62
Z33QLTEPA040	565	40	185	75	130	70
Z33QLTEPA050	230	50	216	87	152	79
Z33QLTEPA063	-	63	-	-	-	-

Z33QLCAPA

Tapón final de línea

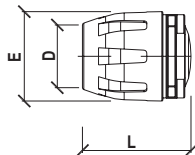

Código	Gr	D	L	E	C
Z33QLCAPA016	30	16	50	37	38
Z33QLCAPA020	58	20	54	45	48
Z33QLCAPA025	75	25	60	51	52
Z33QLCAPA032	126	32	71	61	62
Z33QLCAPA040	200	40	78	75	70
Z33QLCAPA050	298	50	85	87	79
Z33QLCAPA063	-	63	-	-	-

Z33QLTPPA

T de 90° paso de roscado h

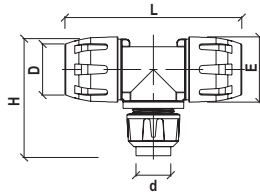

Código**	Gr	D	d	L	E	H	C
Z33QLTPPA020048	160	20	1/2"	127	45	75	48
Z33QLTPPA025048	210	25	1/2"	140	51	80	52

Z33QLTRPA

T de 90° reducida

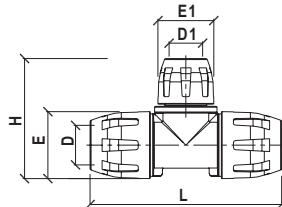

Código	Gr	D	D1	L	E	E1	H	C	C1
Z33QLTRPA020016	150	20	16	127	45	37	80	48	38
Z33QLTRPA025016	200	25	16	140	51	45	88	52	38
Z33QLTRPA025020	210	25	20	140	51	37	98	52	48
Z33QLTRPA032020	340	32	20	170	61	45	111	62	48
Z33QLTRPA032025	340	32	25	170	61	51	113	62	52
Z33QLTRPA040025	510	40	25	185	75	51	128	70	52
Z33QLTRPA040032	540	40	32	185	75	61	131	70	62
Z33QLTRPA050032	760	50	32	216	87	61	147	79	62
Z33QLTRPA050040	820	50	40	216	87	75	150	79	70
Z33QLTRPA063040	-	63	40	-	-	-	-	-	-

** Disponible en NPT

Z33QLRIDPA

Reducción

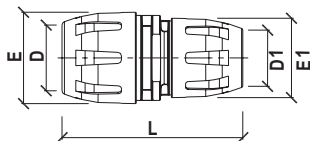

Código	Gr	D	D1	L	E	E1	C	C1
Z33QLRIDPA025020	120	25	20	101	51	45	52	48
Z33QLRIDPA032025	178	32	25	115	61	51	62	52
Z33QLRIDPA040032	290	40	32	133	75	51	70	62
Z33QLRIDPA050040	450	50	40	151	87	75	79	70

Z33QLMNPA

Racor macho (plástico)

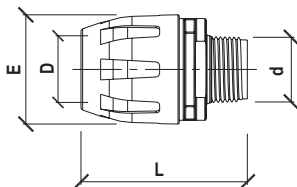

Código**	Gr	D	d	L	E	C
Z33QLMNPA016048	30	16	1/2"	64	37	38
Z33QLMNPA020048	60	20	1/2"	68	45	48
Z33QLMNPA020068	60	20	3/4"	68	45	48
Z33QLMNPA025048	80	25	1/2"	71	51	52
Z33QLMNPA025068	80	25	3/4"	73	51	52
Z33QLMNPA025088	80	25	1"	76	51	52
Z33QLMNPA032088	120	32	1"	85	61	62
Z33QLMNPA032108	130	32	1" 1/4	87	61	62
Z33QLMNPA040088	200	40	1"	96	75	70
Z33QLMNPA040108	200	40	1" 1/4	97	75	70
Z33QLMNPA040128	200	40	1" 1/2	98	75	70
Z33QLMNPA050128	300	50	1" 1/2	108	87	79
Z33QLMNPA050168	290	50	2"	111	87	79
Z33QLMNPA063168	-	63	2"	-	-	-

** Disponible en NPT

Z33QLMNM

Racor macho (cuerpo en aluminio)

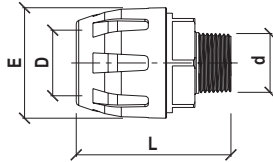

Código**	Gr	D	d	L	E
Z33QLMNM020048	100	20	1/2"	67	45
Z33QLMNM020068	110	20	3/4"	67	45
Z33QLMNM025088	130	25	1"	76	51
Z33QLMNM032108	220	32	1" 1/4	87	61
Z33QLMNM040128	420	40	1" 1/2	98	75
Z33QLMNM050168	580	50	2"	111	87

Z33QLMPM

Racor hembra (cuerpo en aluminio)

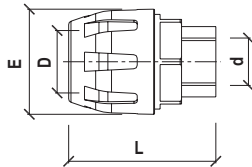

Código**	Gr	D	d	L	E	C
Z33QLMPM020048	110	20	1/2"	67	45	48
Z33QLMPM020068	110	20	3/4"	67	45	48
Z33QLMPM025088	150	25	1"	76	51	52
Z33QLMPM032108	230	32	1" 1/4	87	61	62
Z33QLMPM040128	460	40	1" 1/2	98	75	70
Z33QLMPM050168	590	50	2"	111	87	79

** Disponible en NPT

Racord de aluminio Quick line Ø 63/80 mm

Z33QLMAAL

Manguito de aluminio

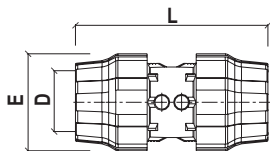

Código	Gr	D	L	E	C
Z33QLMAAL063	890	63	193	97	95
Z33QLMAAL080	1490	80	232	116	114

Z33QLMASAL

Manguito corredizo de aluminio

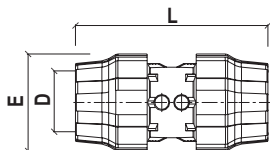

Código	Gr	D	L	E	C
Z33QLMASAL063	890	63	-	97	95
Z33QLMASAL080	1490	80	-	116	114

Z33QLGO90AL

Codo de 90° de aluminio

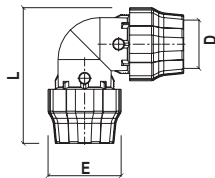

Código	Gr	D	L	E	C
Z33QLGO90AL063	1050	63	180	97	95
Z33QLGO90AL080	1800	80	217	116	114

Z33QLTEAL

Te de 90° de aluminio

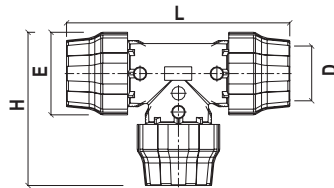

Código	Gr	D	L	H	E	C
Z33QLTEAL063	1280	63	263	97	181	95
Z33QLTEAL080	2580	80	3180	116	217	114

Z33QLCAAL

Tapón final de línea de aluminio

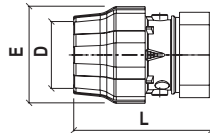

Código	Gr	D	L	E	H
Z33QLCAAL063	1230	63	139	97	95
Z33QLCAAL080	1560	80	163	116	114

Z33QLTPAL

T de 90° paso roscado h de aluminio

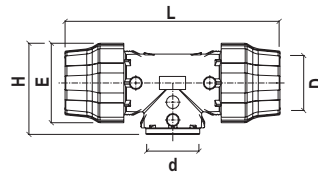

Código**	Gr	D	d	L	E	H	C
Z33QLTPAL063168	1180	63	2"	263	97	112	95
Z33QLTPAL080208	1850	80	2" 1/2	318	116	136	114

** Disponible en NPT

Z33QLNMAL

Racor macho cuerpo de aluminio

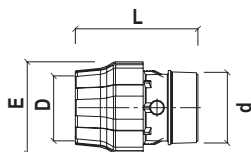

Código**	Gr	D	D	L	E	C
Z33QLNMAL063208	520	63	2" 1/2	130	97	95
Z33QLNMAL080208	850	80	2" 1/2	152	116	114
Z33QLNMAL080248	870	80	3"	155	116	114

Z33QLMPMAL

Racor hembra cuerpo de aluminio

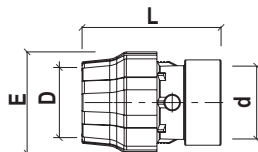

Código**	Gr	D	d	L	E	C
Z33QLMPMAL	560	63	2" 1/2	134	97	95

** Disponible en NPT

Apliques Quick Line

Z33QLAPM

Aplique mural mono QL/h

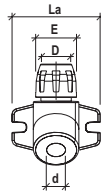
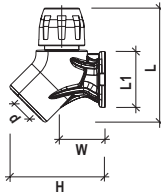

Codigo**	Gr	D	d	L	L1	La	H	E	W	C
Z33QLAPM016	120	16	1/2"	94	45	80	41	37	35	38
Z33QLAPM020	190	20	1/2"	96	45	80	41	45	35	48

Z33QLAPMVA

Aplique mural mono con válvula QL/h

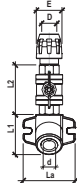
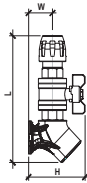

Codigo**	Gr	D	d	L	L1	L2	La	H	E	W	C
Z33QLAPMVA016	340	16	1/2"	158	57	59	80	94	37	35	38
Z33QLAPMVA020	460	20	1/2"	180	57	68	80	96	45	35	48
Z33QLAPMVA025	470	25	1/2"	185	57	68	80	96	51	35	52

Z33QLAPL

Aplique mural mono h/h

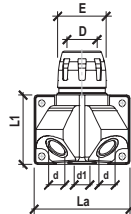
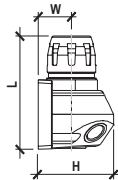

Codigo**	Gr	D	d	L	L1	L2	La	H	E	W	C
Z33QLAPL016	270	16	1/2"	1/4"	100	68	99	78	37	35	38
Z33QLAPL020	320	20	1/2"	1/4"	110	68	99	78	45	35	48
Z33QLAPL025	330	25	1/2"	1/4"	110	68	99	78	51	35	52

** Disponible en NPT

Z33QLAPLVA

Aplique mural double con válvula QL/h

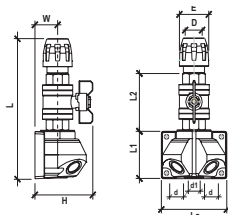

Codigo**	Gr	D	d	d1	L	L1	L2	La	H	E	W	C
Z33QLAPLVA016	520	16	1/2"	1/4"	180	68	59	99	78	37	35	38
Z33QLAPLVA020	660	20	1/2"	1/4"	200	68	68	99	85	45	35	48
Z33QLAPLVA025	675	25	1/2"	1/4"	200	68	68	99	85	51	35	52

Z33QLPMU

Aplique múltiple 10 salidad

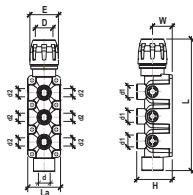

Codigo**	Gr	D	d	d1	d2	H	L	La	E	W	C
Z33QLPMU020028038	315	20	1/2"	3/8"	1/4"	64	205	58	45	44	48
Z33QLPMU025028038	320	25	1/2"	3/8"	1/4"	64	210	58	51	44	52

Z33QLPMUVA

Aplique múltiple 10 salidas con válvula QL

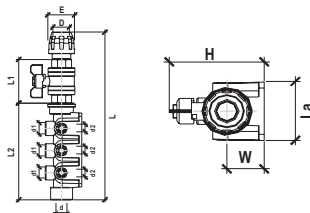

Codigo	Gr	D	d	d1	d2	L	L1	L2	La	H	E	W	C
Z33QLPMUVA020028038	510	20	1/2"	3/8"	1/4"	275	59	168	58	80	45	44	48
Z33QLPMUVA025028038	650	25	1/2"	3/8"	1/4"	290	68	168	58	90	51	44	52

** Disponible en NPT

Z33QLPCR

Aplique en cruz QL/h/h

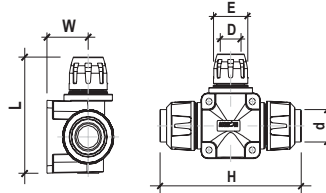

Codigo	Gr	D	d	L	H	E	W	C
Z33QLPCR020048	400	20	1/2"	125	170	45	44	48
Z33QLPCR025048	405	25	1/2"	125	170	51	44	52

Z33QLPCRVA

Aplique en cruz con válvula QL/h/h

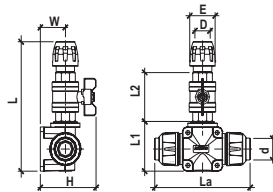

Codigo**	Gr	D	d	L	L1	L2	La	H	E	W	C
Z33QLPCRVA020048	720	20	1/2"	196	85	59	170	80	45	44	48
Z33QLPCRVA025048	725	25	1/2"	196	85	68	170	90	51	44	52

Z33QLFLEX

Compensador flexible de dilatación

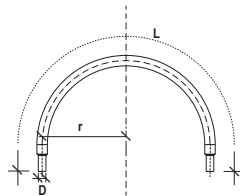

Codigo	Gr	D	⟨ r ⟩		L
Z33QLFLEX020	420	20	15	20	80
Z33QLFLEX025	760	25	18	25	99
Z33QLFLEX032	1430	34	23	32	125
Z33QLFLEX040	1900	40	29	38	154
Z33QLFLEX050	3500	50	36	47	190
Z33QLFLEX063	5000	63	45	59	238

** Disponible en NPT

Z33QLDERPA

Toma rápida de derivación

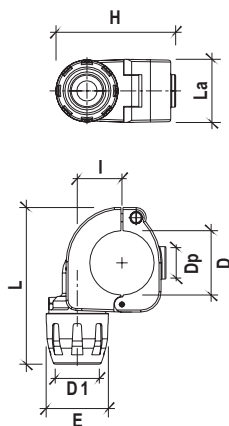

Código	Gr	D	D1	L	E	La	Dp
Z33QLDERPA025016	210	25	16	113	37	52	16
Z33QLDERPA025020	230	25	20	113	45	52	16
Z33QLDERPA032016	200	32	16	113	37	52	16
Z33QLDERPA032020	220	32	20	113	45	52	16
Z33QLDERPA040016	250	40	16	125	37	52	20
Z33QLDERPA040020	270	40	20	125	45	52	20
Z33QLDERPA040025	280	40	25	125	51	52	20
Z33QLDERPA050016	420	50	16	145	37	60	20
Z33QLDERPA050020	420	50	20	145	45	60	20
Z33QLDERPA050025	430	50	25	145	51	60	20
Z33QLDERPA063020	400	63	20	145	45	60	20
Z33QLDERPA063025	410	63	25	145	51	60	20
Z33QLDERPA063032	420	63	32	148	61	60	20
Z33QLDERPA080020	1110	80	20	220	45	63	22,5
Z33QLDERPA080025	1120	80	25	220	51	63	22,5
Z33QLDERPA080032	1130	80	32	220	61	63	22,5

Z33QLPUNM

Espiga de aluminio macho

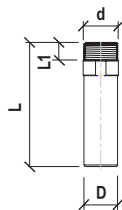

Código	Gr	D	d	L	L1	E	W	C
Z33QLPUNM020048	36	20	1/2"	95	13	45	44	48
Z33QLPUNM020068	-	20	3/4"	-	-	51	44	52
Z33QLPUNM025088	-	25	1"	-	-	-	-	-
Z33QLPUNM032108	95	32	1" 1/4	119	18	-	-	-
Z33QLPUNM040128	-	40	1" 1/2	-	-	-	-	-
Z33QLPUNM063168	-	63	2"	-	-	-	-	-
Z33QLPUNM080248	-	80	3"	-	-	-	-	-

Apliques Quick Classic Freeze Line

Z33DIRAPMFF

Aplique mural mono h/h

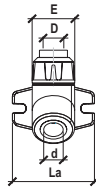
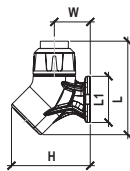

Codigo	Gr	G	G1	L	H	H1	E	W
Z33DIRPMMFF048038	190	1/2"	3/8"	80	94	45	37	35
Z33DIRPMMFF048048	200	1/2"	1/2"	80	96	45	45	35

Z33DIRAPLFF

Aplique mural doble h/h

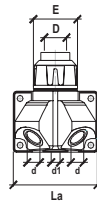
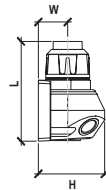

Codigo	Gr	G	G1	G2	L	H	H1
Z33DIRAPLFF048048	330	1/2"	1/2"	1/4"	100	112	68
Z33DIRAPLFF068048	350	3/4"	1/2"	1/4"	100	114	68

Z33DIRPCR

Aplique mural en cruz h/h/h

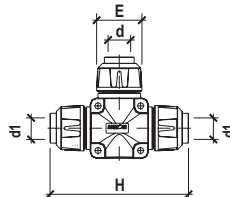
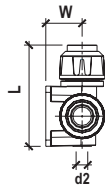

Codigo	Gr	G	G1	G2	L	L1	H	H1	W
Z33DIRPCR048048	435	20	1/2"	1/4"	160	70	114	60	35

Z33DIRPMU

Aplique múltiple 10 salidad h/h

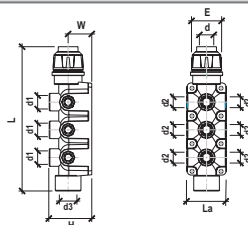

Codigo	Gr	G	G1	G2	G3	E	H	H1	L	P
Z33DIRPMU048028038	312	1/2"	1/4"	3/8"	1/2"	37	201	138	58	62

Z33DIRDERFF

Toma rápida de derivación roscada h latón

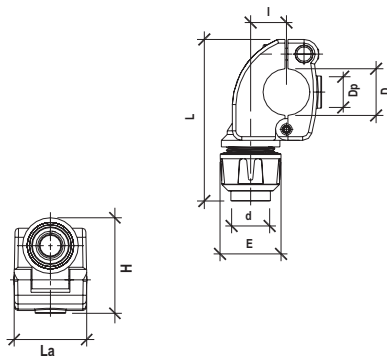

Codigo**	Gr	D	d	L	E	La	Dp	I
Z33DIRDERFF025048	240	25	1/2"	113	45	52	16	24,5
Z33DIRDERFF032048	230	32	1/2"	113	45	52	16	24,5
Z33DIRDERFF040048	260	40	1/2"	125	45	52	20	29,6
Z33DIRDERFF040068	300	40	3/4"	125	51	52	20	29,6
Z33DIRDERFF050048	460	50	1/2"	145	45	60	20	31
Z33DIRDERFF050068	550	50	3/4"	145	51	60	20	31
Z33DIRDERFF063048	420	63	1/2"	145	45	60	20	43
Z33DIRDERFF063068	520	63	3/4"	145	51	60	20	43
Z33DIRDERFF063088	620	63	1"	148	61	60	20	43
Z33DIRDERFF080048	1120	80	1/2"	220	45	63	22,5	71
Z33DIRDERFF080068	1240	80	3/4"	220	51	63	22,5	71
Z33DIRDERFF080088	1350	80	1"	220	61	63	22,5	71

** Disponible en NPT

Válvula de comando neumático

Z33QLVAVIP

Válvula comando neumático

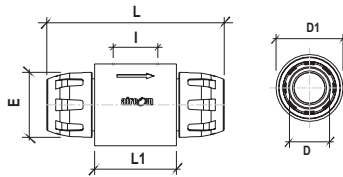

Código	Gr	D	D1	L	L1	I	E	C
Z33QLVAVIP032	-	32	-	-	-	-	-	-
Z33QLVAVIP040	-	40	-	-	-	-	-	-
Z33QLVAVIP050	2120	50	109	245	110	57	87	70
Z33QLVAVIP063	-	63	140	290	140	60	97	95

Z33QLKITVA

Kit de pilotaje para válvula neumática



Código				
Z33QLKITVA				

Válvula de comando neumático

Z33QLVAM

Válvula de esfera macho derivación QL

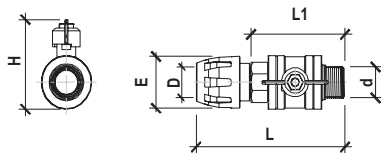
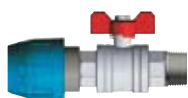

Código	Gr	D	d	L	L1	H	E	C
Z33QLVAM016048	223	16	1/2"	104	60	58	37	38
Z33QLVAM020048	364	20	1/2"	125	70	68	45	48
Z33QLVAM020068	-	20	3/4"	-	-	-	-	-
Z33QLVAM025068	375	25	3/4"	127	70	73	51	52

Z33QLVAF

Válvula de esfera hembra derivación QL

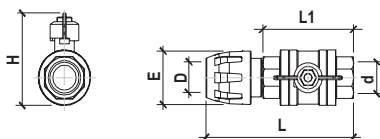
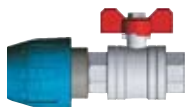

Código	Gr	D	d	L	L1	H	E	C
Z33QLVAF016048	223	16	1/2"	102	59	58	37	38
Z33QLVAF020048	-	20	1/2"	-	-	-	-	-
Z33QLVAF020068	364	20	3/4"	123	68	68	45	48
Z33QLVAF025068	375	25	3/4"	125	68	73	51	52

Tubo Classic Line

Z33AIRTU

Tubo Classic



d	dn	Código	imb	Pn	espesor		P.Kg/m	d.int	C
20	15	Z33AIRTU020	80	13	2,1	0,19	15,8	-	
25	20	Z33AIRTU025	60	13	2,5	0,3	20	-	
32	25	Z33AIRTU032	40	13	3,2	0,49	25,6	70	
40	32	Z33AIRTU040	20	13	3,8	0,76	32,4	95	
50	40	Z33AIRTU050	16	13	4,9	1,19	40,2		
63	50	Z33AIRTU063	12	13	5,8	1,9	51,4		
90	80	Z33AIRTU090	4	13	7,7	3,84	74,6		
110	100	Z33AIRTU110	4	13	9,5	4,86	91		

Z33AIRC180

Curva 180°



Código				
Z33AIRC180				

Racor Classic Line

Z33AIRMA

Manguito h/h

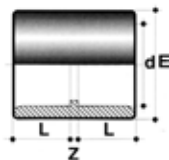

d	dn	Código	imb	L	Z	E	gr
20	15	Z33AIRMA020	10	16	3	28	15
25	20	Z33AIRMA025	10	19	3	34	23
32	25	Z33AIRMA032	10	22	3	42	36
40	32	Z33AIRMA040	10	26	3	51	60
50	40	Z33AIRMA050	10	31	3	61	85
63	50	Z33AIRMA063	5	38	3	75	145
90	80	Z33AIRMA090	5	51	5	106	353
110	100	Z33AIRMA110	5	61	6	129	605

Z33AIRGO90

Codo de 90°

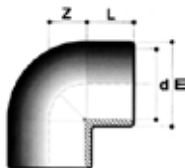

d	dn	Código	imb	L	Z	E	gr
20	15	Z33AIRGO90020	10	16	11	26,5	20
25	20	Z33AIRGO90025	10	19	14	32,5	35
32	25	Z33AIRGO90032	10	22	17	41	50
40	32	Z33AIRGO90040	10	26	23	50	90
50	40	Z33AIRGO90050	10	31	28	60	135
63	50	Z33AIRGO90063	5	38	34	75	247
90	80	Z33AIRGO90090	5	51	48	106	620
110	100	Z33AIRGO90110	5	61	58	129	1060

Z33AIRGO45

Codo de 45°

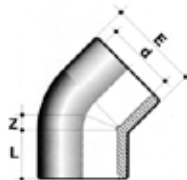

d	dn	Código	imb	L	Z	E	gr
20	15	Z33AIRGO45020	10	16	5,5	28	17
25	20	Z33AIRGO45025	10	19	6	34	30
32	25	Z33AIRGO45032	10	22	8	42	47
40	32	Z33AIRGO45040	10	26	10	51	77
50	40	Z33AIRGO45050	10	31	12	61	115
63	50	Z33AIRGO45063	5	38	15	75	190
90	80	Z33AIRGO45090	5	51	21	106	485
110	100	Z33AIRGO45110	5	61	25	128	835

Z33AIRTE

Te de 90°

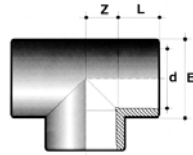

d	dn	Código	imb	L	Z	E	gr
20	15	Z33AIRTE020	10	16	11	27,5	25
25	20	Z33AIRTE025	10	19	14	33,5	44
32	25	Z33AIRTE032	10	22	17	42	75
40	32	Z33AIRTE040	10	26	21	51	120
50	40	Z33AIRTE050	10	31	26	61	183
63	50	Z33AIRTE063	5	38	33	75	315
90	80	Z33AIRTE090	5	51	47	106	790
110	100	Z33AIRTE110	5	61	57	129	1330

Z33AIRCA

Tápon final de línea

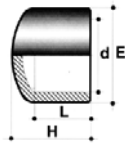

d	dn	Código	imb	L	H	E	gr
20	15	Z33AIRCA020	10	16	27	28	10
25	20	Z33AIRCA025	10	19	31	33	18
32	25	Z33AIRCA032	10	22	36	41	30
40	32	Z33AIRCA040	10	26	43	50	45
50	40	Z33AIRCA050	10	31	49	60	70
63	50	Z33AIRCA063	5	38	57	75	120
90	80	Z33AIRCA090	5	51	80	106	295
110	100	Z33AIRCA110	5	61	92	129	490

Z33AIRBO

Union h/h

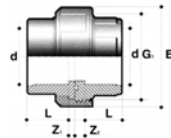

d	dn	Código	imb	L	Z	E	gr
20	15	Z33AIRBO020	10	16	13	42	42
25	20	Z33AIRBO025	10	19	13	52	70
32	25	Z33AIRBO032	10	22	13	59	97
40	32	Z33AIRBO040	10	26	15	72	155
50	40	Z33AIRBO050	10	31	17	79	216
63	50	Z33AIRBO063	5	38	21	96	340

Z33AIRTR

T reduccion de 90°

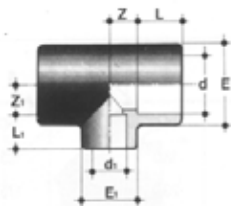

dxd1	dn	Código	imb	L	L1	Z	E	E1	gr
25x20	20x15	Z33AIRTRO25020	10	19	16	14	33,5	28	42
32x20	25x15	Z33AIRTRO32020	10	22	16	17	42	28	69
32x25	25x20	Z33AIRTRO32025	10	22	19	17	42	33	70
40x20	32x15	Z33AIRTRO40020	10	26	16	21	51	28	112
40x25	32x20	Z33AIRTRO40025	10	26	19	21	51	34	115
50x20	40x15	Z33AIRTRO50020	10	31	19	26	61	28	155
50x25	40x20	Z33AIRTRO50025	10	31	16	26	61	34	166
50x32	40x25	Z33AIRTRO50032	10	31	22	26	61	42	170
63x20	50x15	Z33AIRTRO63020	5	38	16	33	75	28	268
63x25	50x20	Z33AIRTRO63025	5	38	19	33	75	34	270
63x32	50x25	Z33AIRTRO63032	5	38	22	33	75	42	275
90x40	80x32	Z33AIRTRO90040	5	51	26	47	106	51	702
110x50	100x40	Z33AIRTR110050	5	61	31	57	129	61	1250

Z33AIRBR

Empalme reducción

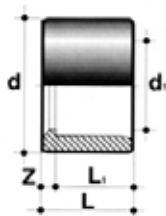

d	dn	Código	imb	L	L1	ZZ1	gr
25x20	20x15	Z33AIRBRO25020	10	19	16	3	6
32x20	25x15	Z33AIRBRO32020	10	22	16	6	15
32x25	25x20	Z33AIRBRO32025	10	22	19	3	10
40x20	32x15	Z33AIRBRO40020	10	26	16	10	29
40x25	32x20	Z33AIRBRO40025	10	26	19	7	28
40x32	32x25	Z33AIRBRO40032	10	26	22	4	19
50x25	40x20	Z33AIRBRO50025	10	31	19	12	45
50x32	40x25	Z33AIRBRO50032	10	31	22	9	45
50x40	40x32	Z33AIRBRO50040	10	31	26	5	35
63x32	50x25	Z33AIRBRO63032	5	38	22	16	83
63x40	50x32	Z33AIRBRO63040	5	38	26	12	83
63x50	50x40	Z33AIRBRO63050	5	38	31	7	61
90x50	80x40	Z33AIRBRO90050	2	51	31	20	210
90x63	80x50	Z33AIRBRO90063	2	51	38	13	180
110x63	100x50	Z33AIRBR110063	2	61	38	23	372
110x90	100x80	Z33AIRBR110090	2	61	51	10	262

Z33AIRDER

Toma rápida de derivación h

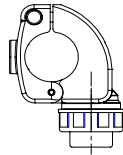

dxdl	dn	Código	imb	L	L1	Z	E	E1	gr
25x20		Z33AIRDERO25020							
32x20		Z33AIRDERO32020							
40x20		Z33AIRDERO40020							
40x25		Z33AIRDERO40025							
50x20		Z33AIRDERO50020							
50x25		Z33AIRDERO50025							
63x20		Z33AIRDERO63020							
63x25		Z33AIRDERO63025							
63x32		Z33AIRDERO63032							

Z33AIRDERFF

Toma rápida de derivación roscada h latón

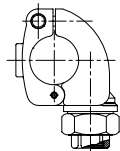

dxdl	dn	Código	imb	L	L1	Z	E	E1	gr
25x48		Z33AIRDERFFO25048	5						
32x48		Z33AIRDERFFO32048	5						
40x48		Z33AIRDERFFO40048	5						
40x68		Z33AIRDERFFO40068	5						
50x48		Z33AIRDERFFO50048	5						
50x68		Z33AIRDERFFO50068	5						
63x48		Z33AIRDERFFO63048	5						
63x68		Z33AIRDERFFO63068	5						
63x88		Z33AIRDERFFO63088	5						

Z33AIRCO

Asiento plano

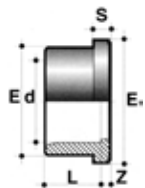

d	dn	Código	imb	L	Z	S	E	E1	gr
32	25	Z33AIRCO032	6	22	3	7	41	50	25
40	32	Z33AIRCO040	6	26	3	8	50	61	40
50	40	Z33AIRCO050	6	31	3	8	61	73	60
63	50	Z33AIRCO063	6	38	3	9	76	90	113
90	80	Z33AIRCO080	2	51	5	11	108	125	263
110	100	Z33AIRCO110	2	61	5	12	131	150	420

Z33AIRFLPP

Brid libre

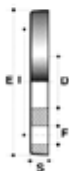

D	dn	Código	imb	D	E	S	I	F	agu- jeros	Bulloni	gr
32	25	Z33AIRFLPP032	6	42	115	12	85	14	4	M12x60	250
40	32	Z33AIRFLPP040	6	51	140	16	100	18	4	M12x60	500
50	40	Z33AIRFLPP050	6	63	150	16	110	18	4	M12x60	570
63	50	Z33AIRFLPP063	6	78	165	20	125	18	4	M16x80	690
90	80	Z33AIRFLPP090	2	109	200	22	160	18	8	M16x90	970
110	100	Z33AIRFLPP110	2	133	220	22	180	18	8	M16x100	1040

Z33AIRMP

Recto h/h rosca metalica

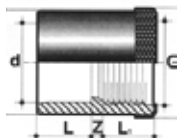

dxG	Código	imb	L	L1	Z	E	E1	gr
20x1/2"	Z33AIRMP050048	10	16	15	4	28	29	23
25x3/4"	Z33AIRMP025068	10	19	16,3	6	34	35	32
32x1"	Z33AIRMP032088	10	22	19,1	6	42	43	47
40x1" 1/4	Z33AIRMP040108	10	26	21,4	8	50,5	51,5	78
50x1" 1/2	Z33AIRMP050128	10	31	21,4	13	61	62	107
63x2"	Z33AIRMP063168	5	38	25,7	15	75	76	180

Z33AIRAP

Recto m/h rosca metálica

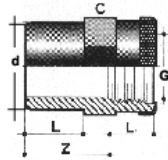

dxG	Código	imb	L	L1	E	Z	C	gr
40x1" 1/4	Z33AIRAPO40108	10	26	21,4	51,5	36	55	75
50x1" 1/2	Z33AIRAPO50128	10	31	21,4	61	41	60	92
63X 2"	Z33AIRAPO63168	5	38	25,7	76	48	75	150

Z33AIRMN

Racor macho

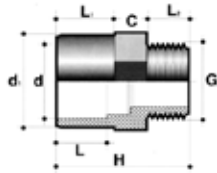

dxdlxG	Código	imb	L	L1	L2	H	C	gr
16x20x3/8	Z33AIRMNO16038	10	14	14	11,4	40	24	10
16x20x1/2	Z33AIRMNO16048	10	16	16	15	43	24	11
20x25x1/2	Z33AIRMNO20048	10	16	16	15	46	27	15
20x25x3/4	Z33AIRMNO20068	10	19	19	16,3	47	30	18
25x32x3/4	Z33AIRMNO25068	10	19	19	16,3	50	36	26
25x32x1"	Z33AIRMNO25088	10	22	22	19,1	53	36	30
32x40x1"	Z33AIRMNO32088	10	26	26	19,1	57	42	40
32x40x1" 1/4	Z33AIRMNO32108	10	26	26	21,4	6	46	45
40x50x1" 1/4	Z33AIRMNO40108	10	31	31	21,4	66,5	55	75
40x50x1" 1/2	Z33AIRMNO40128	10	31	31	21,4	66,5	55	77
50x63x1" 1/2	Z33AIRMNO50128	10	38	38	21,4	74	65	113
50x63x2"	Z33AIRMNO50168	5	38	38	25,7	78	65	120
63x75x2"	Z33AIRMNO63168	5	44	44	25,7	84	75	150

Z33AIRBPO

Recto h/h en laton

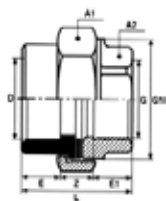

dxG	Código	imb	Z	E	E1	G1	A1	A2	L
20x1/2	Z33AIRBPO20048	5	13	16	16	1"	36	27	45
25x3/4	Z33AIRBPO25068	5	12	19	17	1" 1/4	45	32	48
32x1"	Z33AIRBPO32088	5	14	22	19	1" 1/2	52	38	55
40x1" 1/2	Z33AIRBPO40108	5	14	26	22	2"	66	47	62
50x1" 1/2	Z33AIRBPO50128	5	13	31	23	1" 1/4	72	53	67
63x2"	Z33AIRBPO63168	5	12	38	27	2" 3/4	89	65	77

Z33AIRBPM

Recto m/h en laton

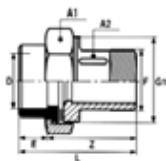

dxF	Código	imb	dn	Z	E	A1	A2	G1	L
20x1/2"	Z33AIRBPM20048	5	15	33	18	36	21	1"	51
25x3/4"	Z33AIRBPM25068	5	20	51	19	45	28	1" 1/4	70
32x1"	Z33AIRBPM32088	5	25	56	23	52	33	1" 1/2	78
40x1" 1/4	Z33AIRBPM40108	5	32	58	27	66	42	2"	85
50x1" 1/2	Z33AIRBPM50128	5	40	63	32	72	48	2" 1/4	95
63x2"	Z33AIRBPM63168	5	50	70	38	89	62	2" 3/4	108

Z33AIRGP

Codo de 90° rosca metalica

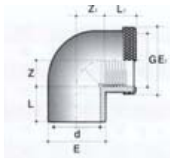

dxG	Código	imb	L	L1	Z	Z1	E	gr
20x1/2"	Z33AIRGP020048	10	16	15	11	46	26,5	15
25x3/4"	Z33AIRGP025068	10	19	16,3	14	50	32,5	27
32x1"	Z33AIRGP032088	10	22	19,1	17	57	41	48

Z33AIRTP

T h/h/h rosca metálica

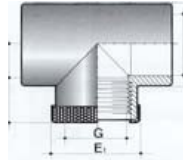

dxG	Código	imb	L	L1	Z	Z1	E	gr	L
20x1/2"	Z33AIRTP020048	10	16	15	11	12	27,5	25	51
25x3/4"	Z33AIRTP025068	10	19	16,3	14	16,7	33,5	38	70
32x1"	Z33AIRTP032088	10	22	19,1	17	19,9	42	69	78

Z33AIRCR

Cruz de 90° h/h/h/h

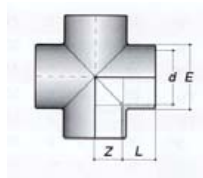

d	dn	Código	imb	L	Z	E	gr
20	15	Z33AIRCRO020	5	16	11	27,5	26
25	20	Z33AIRCRO025	5	19	14	33,5	41
32	25	Z33AIRCRO032	5	22	17	42	72
40	32	Z33AIRCRO040	5	26	21	51	114
50	40	Z33AIRCRO050	5	31	26	61	233
63	50	Z33AIRCRO063	5	38	33	75	411

Tubo linea Freeze

FRETU

Tubo linea Freeze - Tubo linea Freeze - Freeze line pipe

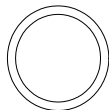

d	dn	Código	imb	Pn	espesor	P.Kg/m	d.int
20	15	Z33FRETU020	80	13	2,1	0,19	15,8
25	20	Z33FRETU025	60	13	2,5	0,3	20
32	25	Z33FRETU032	40	13	3,2	0,49	25,6
40	32	Z33FRETU040	20	13	3,8	0,76	32,4
50	40	Z33FRETU050	16	13	4,9	1,19	40,2
63	50	Z33FRETU063	12	13	5,8	1,9	51,4
75	65	Z33FRETU075	8	13	6,6	2,69	61,8
90	80	Z33FRETU090	4	13	7,7	3,84	74,6
110	100	Z33FRETU110	4	13	9,5	4,86	91

Racord Freeze Line

Z33FREMA

Manguito h/h

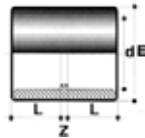

d	dn	Código	imb	L	Z	E	gr
20	15	Z33FREMAO	10	16	3	28	15
25	20	Z33FREMAO	10	19	3	34	23
32	25	Z33FREMAO	10	22	3	42	36
40	32	Z33FREMAO	10	26	3	51	60
50	40	Z33FREMAO	10	31	3	61	85
63	50	Z33FREMAO	5	38	3	75	145
75	65	Z33FREMAO	2	44	4	88	222
90	80	Z33FREMAO	5	51	5	106	353
110	100	Z33FREMAO	5	61	6	129	605

Z33FREGO90

Codo de 90°

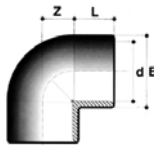

d	dn	Código	imb	L	Z	E	gr
20	15	Z33FREGO90	10	16	11	26,5	20
25	20	Z33FREGO90	10	19	14	32,5	35
32	25	Z33FREGO90	10	22	17	41	50
40	32	Z33FREGO90	10	26	23	50	90
50	40	Z33FREGO90	10	31	28	60	135
63	50	Z33FREGO90	5	38	34	75	247
75	65	Z33FREGO90	2	44	40	89	375
90	80	Z33FREGO90	5	51	48	106	620
110	100	Z33FREGO90	5	61	58	129	1060

Z33FREGO45

Codo de 45°

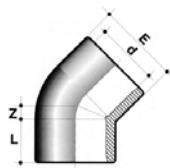

d	dn	Código	imb	L	Z	E	gr
20	15	Z33FREGO45	10	16	5,5	28	17
25	20	Z33FREGO45	10	19	6	34	30
32	25	Z33FREGO45	10	22	8	42	47
40	32	Z33FREGO45	10	26	10	51	77
50	40	Z33FREGO45	10	31	12	61	115
63	50	Z33FREGO45	5	38	15	75	190
75	65	Z33FREGO45	2	44	18	89	310
90	80	Z33FREGO45	5	51	21	106	485
110	100	Z33FREGO45	5	61	25	128	835

Z33FRETE

Te de 90°

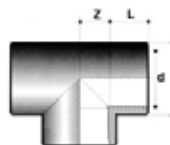

d	dn	Código	imb	L	Z	E	gr
20	15	Z33FRETE020	10	16	11	27,5	25
25	20	Z33FRETE025	10	19	14	33,5	44
32	25	Z33FRETE032	10	22	17	42	75
40	32	Z33FRETE040	10	26	21	51	120
50	40	Z33FRETE050	10	31	26	61	183
63	50	Z33FRETE063	5	38	33	75	315
75	65	Z33FRETE075	2	44	18	89	310
90	80	Z33FRETE090	5	51	47	106	790
110	100	Z33FRETE110	5	61	57	129	1330

Z33FRECA

Tapón final de líneas

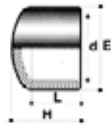

d	dn	Código	imb	L	H	E	gr
20	15	Z33FRECA020	10	16	27	28	10
25	20	Z33FRECA025	10	19	31	33	18
32	25	Z33FRECA032	10	22	36	41	30
40	32	Z33FRECA040	10	26	43	50	45
50	40	Z33FRECA050	10	31	49	60	70
63	50	Z33FRECA063	5	38	57	75	120
75	65	Z33FRECA075	5	44	39	89	495
90	80	Z33FRECA090	5	51	80	106	295
110	100	Z33FRECA110	5	61	92	129	490

Z33FREBO

Union h/h

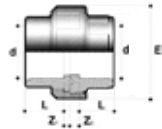

d	dn	Código	imb	L	Z	E	gr
20	15	Z33FREBO020	10	16	13	42	42
25	20	Z33FREBO025	10	19	13	52	70
32	25	Z33FREBO032	10	22	13	59	97
40	32	Z33FREBO040	10	26	15	72	155
50	40	Z33FREBO050	10	31	17	79	216
63	50	Z33FREBO063	5	38	21	96	340
75	65	Z33FREBO075	5	44	21	119	580
90	80	Z33FRECA090	5	51	80	106	295
110	100	Z33FRECA110	5	61	92	129	490

Z33FRETR

T reduccion de de 90°

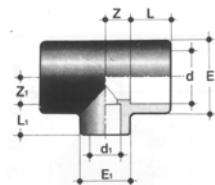

dxd1	dn	Código	imb	L	L1	Z	E	E1	gr
25x20	20x15	Z33FRETRO25020	10	19	16	14	33,5	28	42
32x20	25x15	Z33FRETRO32020	10	22	16	17	42	28	69
32x25	25x20	Z33FRETRO32025	10	22	19	17	42	33	70
40x20	32x15	Z33FRETRO40020	10	26	16	21	51	28	112
40x25	32x20	Z33FRETRO40025	10	26	19	21	51	34	115
50x20	40x15	Z33FRETRO50020	10	31	19	26	61	28	155
50x25	40x20	Z33FRETRO50025	10	31	16	26	61	34	166
50x32	40x25	Z33FRETRO50032	10	31	22	26	61	42	170
63x20	50x15	Z33FRETRO63020	5	38	16	33	75	28	268
63x25	50x20	Z33FRETRO63025	5	38	19	33	75	34	270
63x32	50x25	Z33FRETRO63032	5	38	22	33	75	42	275
75x32	65x25	Z33FRETRO75032	2	44	22	39	89	42	463
90x40	80x32	Z33FRETRO90040	2	51	26	47	106	51	702
110x50	100x40	Z33FRETR110050	2	61	31	57	129	61	1250

Z33FRECO

Asiento plano

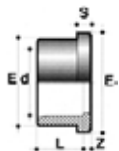

	dn	Código	imb	L	Z	S	E	E1	gr
50	40	Z33FRECO050	6	31	3	8	61	73	60
63	50	Z33FRECO063	6	38	3	9	76	90	113
75	65	Z33FRECO075	2	44	3	10	90	106	160
90	80	Z33FRECO0690	2	51	5	11	108	125	263
110	100	Z33FRECO110	2	61	5	12	131	150	420

Z33FREBR

Empalme reducción

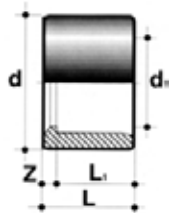

d	dn	Código	imb	L	L1	ZZ1	gr
25X20	20X15	Z33FREBR025020	10	19	16	3	6
32X20	25X15	Z33FREBR032020	10	22	16	6	15
32X25	25X20	Z33FREBR032025	10	22	19	3	10
40X20	32X15	Z33FREBR040020	10	26	16	10	29
40X25	32X20	Z33FREBR040025	10	26	19	7	28
40X32	32X25	Z33FREBR040032	10	26	22	4	19
50X25	40X20	Z33FREBR050025	10	31	19	12	45
50X32	40X25	Z33FREBR050032	10	31	22	9	45
50X40	40X32	Z33FREBR050040	10	31	26	5	35
63X32	50X25	Z33FREBR063032	10	38	22	16	83
63X40	50X32	Z33FREBR063040	10	38	26	12	83
63X50	50X40	Z33FREBR063050	5	38	31	7	61
75X40	65X32	Z33FREBR075040	5	44	26	18	125
75X50	65X40	Z33FREBR075050	5	44	31	13	122
75X63	65X50	Z33FREBR075063	5	44	38	6	85
90X50	80X40	Z33FREBR090050	2	51	31	20	210
90X63	80X50	Z33FREBR090063	2	51	38	13	180
90X75	80X65	Z33FREBR090075	2	51	44	7	140
110X63	100X50	Z33FREBR110063	2	61	38	23	372
110X75	100X65	Z33FREBR110075	2	61	44	17	335
110X90	100X80	Z33FREBR110090	2	61	51	10	262

Z33FREMP

Recto h/h rosca metálica

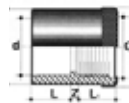

dn	Código	imb	L	L1	Z	E	E1	gr
20x1/2	Z33FREMP020048	10	16	15	4	28	29	23
25x3/4	Z33FREMP025068	10	19	16,3	6	34	35	32
32x1"	Z33FREMP032088	10	22	19,1	6	42	43	47
40x1" 1/4	Z33FREMP040108	10	26	21,4	8	50,5	51,5	78
50x1" 1/2	Z33FREMP050128	10	31	21,4	13	61	62	107
63x2"	Z33FREMP063168	5	38	25,7	15	75	76	180

Z33FREAP

Recto m/h rosca hembra

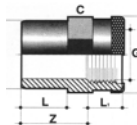

dxg	Código	imb	L	L1	E	Z	C	gr
20x1/2"	Z33FREAPO20048	10	16	15	29	24	30	25
25x3/4"	Z33FREAPO25068	10	19	16,3	35	27	36	32
32x1"	Z33FREAPO32088	10	22	19,1	43	30	46	52
40x1" 1/4	Z33FREAPO40108	10	26	21,4	51,5	36	55	75
50x1" 1/2	Z33FREAPO50128	10	31	21,4	61	41	60	92
63x2"	Z33FREAPO63168	5	38	25,7	76	48	75	150

Z33FREMN

Racord macho

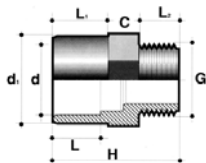

dxG	Código	imb	L	L1	L2	H	C	gr
16x20x1/2"	Z33FREMNO16048	10	14	14	11,4	40	24	10
20x25x1/2"	Z33FREMNO20048	10	16	16	15	46	27	15
20x25x3/4"	Z33FREMNO20068	10	16	16	15	46	27	16
25x32x3/4"	Z33FREMNO25068	10	19	19	16,3	50	36	26
25x32x1"	Z33FREMNO25088	19	19	19	16,3	50	36	28
32x40x1"	Z33FREMNO32088	10	22	26	19,1	57	42	40
32x40x1" 1/4	Z33FREMNO32108	10	22	26	19,1	57	42	45
40x50x1" 1/4	Z33FREMNO40108	10	26	31	21,4	66,5	55	75
40x50x1" 1/2	Z33FREMNO10128	10	26	31	21,4	66,5	55	80
50x63x1" 1/2	Z33FREMNO50128	10	31	38	21,4	74	65	113
50x63x2"	Z33FREMNO50168	10	31	38	21,4	74	65	120
63x75x2"	Z33FREMNO63168	5	38	44	25,7	84	75	150
63x75x2" 1/2	Z33FREMNO63208	5	38	44	26	84	75	160
75x90x2" 1/2	Z33FREMNO75208	5	44	51	30,2	99	95	270

Z33FREGP

Codo de paso 90° rosca metálica

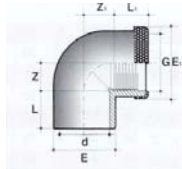

dxG	Código	imb	L	L1	Z	Z1	E	gr
20X1/2"	Z33FREGP020048	10	16	15	11	46	26,5	15
25X3/4"	Z33FREGP025068	10	19	16,3	14	50	32,5	27
32X1"	Z33FREGP032088	10	22	19,1	17	57	41	48

Z33FRETP

T h/h/h rosca metálica

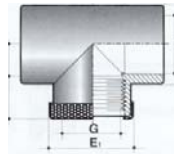

dxG	Código	imb	L	L1	Z	Z1	E	gr
20x1/2"	Z33FRETP020048	10	16	15	11	12	27,5	25
25x3/4"	Z33FRETP025068	10	19	16,3	14	16,7	33,5	38
32x1"	Z33FRETP032088	10	22	19,1	17	19,9	42	69

Z33FREDER

Toma rápida de derivación

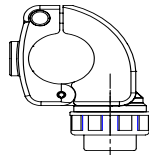

d	Código	imb	E1	E2	H1	H2	gr
25x20	Z33FREDERO25020	5					
32x20	Z33FREDERO32020	5					
40x20	Z33FREDERO40020	5					
40x25	Z33FREDERO40025	5					
50x20	Z33FREDERO50020	5					
50x25	Z33FREDERO50025	5					
63x20	Z33FREDERO63020	5					
63x25	Z33FREDERO63025	5					
63x32	Z33FREDERO63032	5					

Accesorios

Z33DIRFEM8CF

Brida tubo con encastre roscado M8

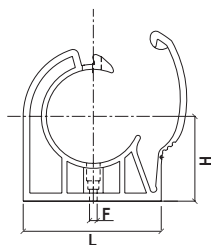

Código	Gr	D	L	H	F	La*
Z33DIRFEM8016CF	9	16	31	35	9	30
Z33DIRFEM8020CF	20	20	31	35	9	30
Z33DIRFEM8025CF	30	25	38	35	9	30
Z33DIRFEM8032CF	70	32	49	35	9	30
Z33DIRFEM8040CF	80	40	60	70	9	40
Z33DIRFEM8050CF	85	50	75	70	9	40
Z33DIRFEM8063CF	110	63	94	70	9	40
Z33DIRFEM8075CF	260	75	118	100	9	49
Z33DIRFEM8080CF	250	80	120	100	9	49
Z33DIRFEM8090CF	240	90	120	100	9	49
Z33DIRFEM80110CF	330	110	163	100	9	49

Z33DIRSPE

Distanciador

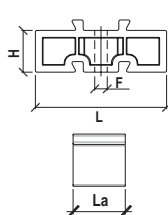
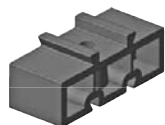
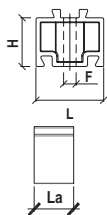

Código	Gr	D	L	E	C	La*
Z33DIRSPE020032	19	20-32	49	35	9	30
Z33DIRSPE040063	55	40-63	94	30	9	40

Z33DIRGM

Aplique mural mono h/h metalico



Código	Ø rosca
Z33DIRGM048048	1/2x1/2

Z33DIRSPE

Aplique mural mono m/h metalico



Código	Ø rosca
Z33DIRGMMF038038	3/8x3/8
Z33DIRGMMF048048	1/2x1/2
Z33DIRGMMF068068	3/4x3/4

Z33DIRFLFF

Brida roscada UNI 2254



Código	Ø
Z33DIRFLFF168	63
Z33DIRFLFF248	80/90

Z33DIRFLPP

Brida de aluminio libre



Código	Ø
Z33DIRFLPP050	50
Z33DIRFLPP063	63

Z33DIRCLDC

Soporte tipo CLDC



Código	Longitud
Z33DIRCLDC15	150 mm
Z33DIRCLDC30	300 mm

Z33DIRCAC

Soporte tipo CAC



Código	Longitud
Z33DIRCAC50	500 mm

Z33DIRLDC Perfil tipo LDC



Código	Longitud
Z33DIRLDC20	2000 mm

Z33DIRM8T Fijación tipo H-TI/T



Código	Apertura
Z33DIRM8T25	3-8 mm
Z33DIRM8T58	8-14 mm

Z33DIRZW Soporte esqdra angular



Código	Longitud
Z33DIRZW205	86x102 mm

Z33DIRZWA

Soporte perfil 90°



Código	dim
Z33DIRZWA224	20

Z33DIREBC

Soporte para viga tipo EBC



Código	apertura
Z33DIREBC	< 16 mm

Z33DIRTMN

Soporte tornillo premontado TMN-M8



Código	longitud
Z33DIRTMN3	20 mm
Z33DIRTMN4	40 mm
Z33DIRTMN5	50 mm
Z33DIRTMN6	60 mm
Z33DIRTMN7	70 mm
Z33DIRTMN10	100 mm

Z33DIRSLICK

Slick - M8



Código	Longitud
Z33DIRSLICK5	50 mm
Z33DIRSLICK7	70 mm

Z33AIRDE

Decapante (para tubería Classic y Freeze Line)



Código	
Z33AIRDE	

Z33AIRSO

Cola super rápida (para tubería Classic y Freeze Line)



Código	
Z33AIRSO	

Z33QLCLE Liaves para uniones Quick Line



Código	Ø
Z33QLCLE016020	16-20
Z33QLCLE025032	25-32
Z33QLCLE040050	40-50
Z33QLCLE063	63
Z33QLCLE080	80

Z33QLMIS Cala 16-80 mm



Código	Ø
Z33QLMIS016080	16-80

Z33DIRSM Cono desbarador



Código	Ø
Z33DIRSM016050	16-50
Z33DIRSM063110	63-110

Valvulas de esfera

Z33AIRVA

Válvula de esfera h para encolar

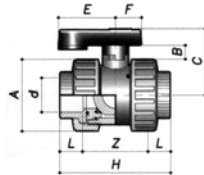

d	dN	Código	L	Z	H	A	B	C	E	F
20	15	Z33AIRVA0020	16	48	80	50	10	48	39	19
25	20	Z33AIRVA0025	19	53	91	60	11	54	47	22
32	25	Z33AIRVA0032	22	58	102	68	13	62	55	25
40	32	Z33AIRVA0040	26	68	120	80	18	75	60	30
50	40	Z33AIRVA0050	31	78	140	96	20	87	68	35
63	50	Z33AIRVA0063	38	93	169	116	20	101	80	40

Z33AIRVAI

Válvula de esfera industria h para encolar

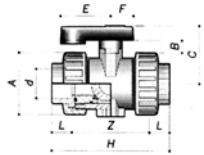

d	dN	Código	L	Z	H	A	B	C	E	F
32	25	Z33AIRVAI32	22	84	128	68	13	62	55	25
40	32	Z33AIRVAI40	26	95	147	80	18	75	60	30
50	40	Z33AIRVAI50	31	101	163	96	20	87	68	25
63	50	Z33AIRVAI63	38	121	197	116	20	101	80	40
90	80	Z33AIRVAI90	51	139	241	166	28	138	100	50
110	100	Z33AIRVAI110	61	159	281	210	28	160	120	60

Z33AIRVAM

Válvula de esfera h/h para encolar y rosca

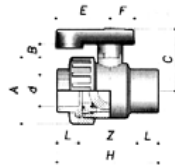

d	dN	Código	L	Z	H	A	B	C	E	F
20x1/2	15	Z33AIRVAM0048	16	44	76	50	10	48	39	19
35x3/4	20	Z33AIRVAM0068	19	52	90	60	11	54	47	22

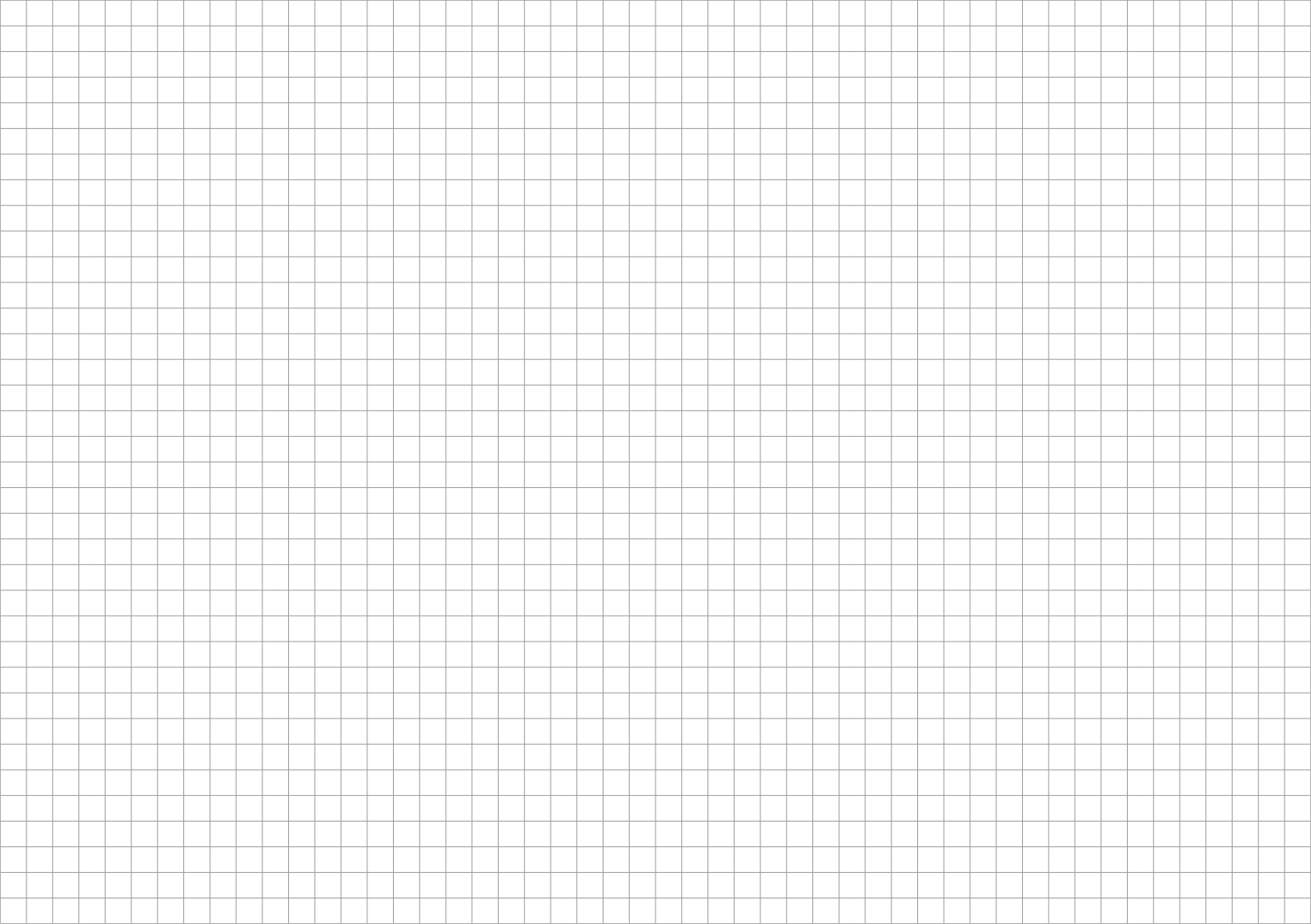

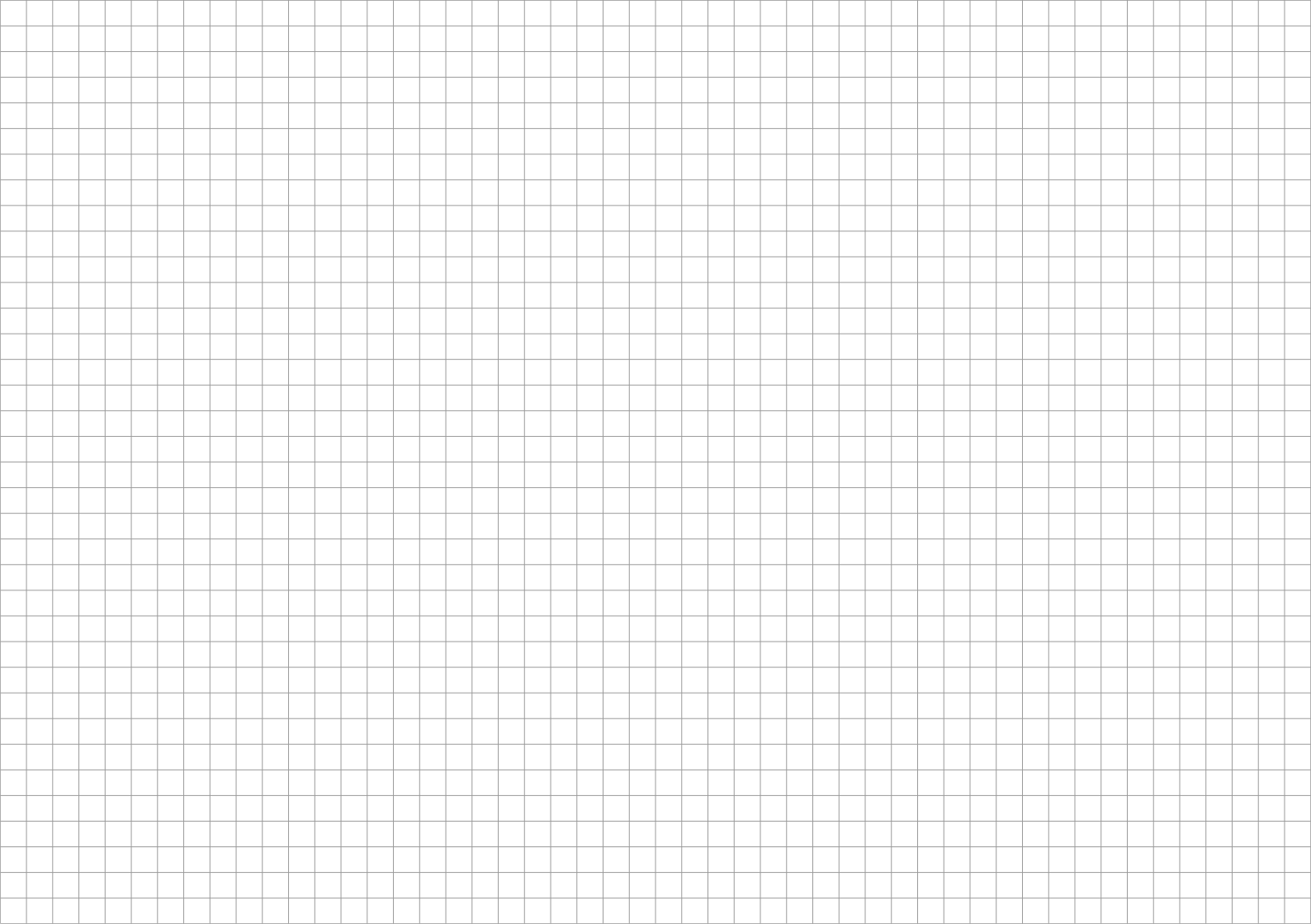



Metal Work Iberica S.A.

Pol. Ind. Can Magí - c/Can Magí, 9
08210 Barbera del Valles (Barcelona) Spain
Tel. 0034 937 180 244 - Fax 0034 937 188 070
metalwork@metalwork.es - www.metalwork.es